

75.11.689

Jefferson County  
VF CEMETERYS

# Sketch Showing the County Cemetery located in Sec. 3, T30N, R1W

Scale 50 FT = 1 IN

J. B. Hoag,  
Co. Surveyor,  
Dec. 1899.

LAUREL GROVE MASONIC CEMETERY

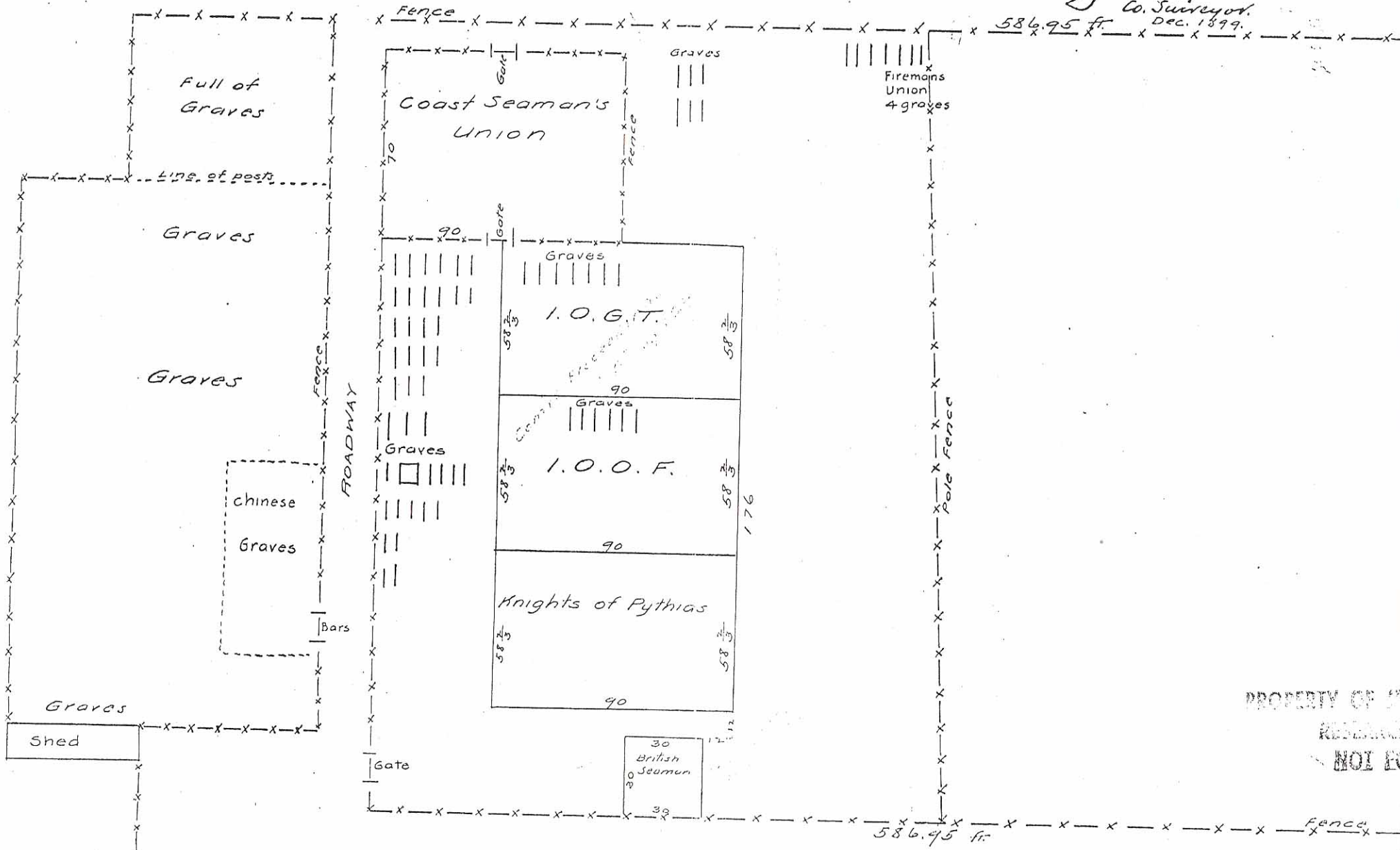

PROPERTY OF  
RECORD  
NOI